

[This transcript of Dr Fred Freeman's notes (No known Ishval number) was by Eleanor Grundy and Alan Roberts in June 2012 - all additions to the original are in square brackets and italics. Crossings out in this piece of work have the same content as in the original, which were also crossed out and usually incomplete sentences. Fred's drawings in the margins and between sentences have been included at that place and as close to the form of them as we can get.]

[1]

Time and Eternity
(Eugene) 27.09.1970

Our sense organs are "directional" in some sense.
Therefore we select some particular aspects
Serial mode of presentation of reality.

Existentially seriality requires "energy emission" in the organ itself *
(due to turning of head etc).

EMIT = TIME (spelt backwards)

not "word jugglery"
written tradition does not contain real secrets, it is "oral tradition".

secret = sacred (both refer to power).

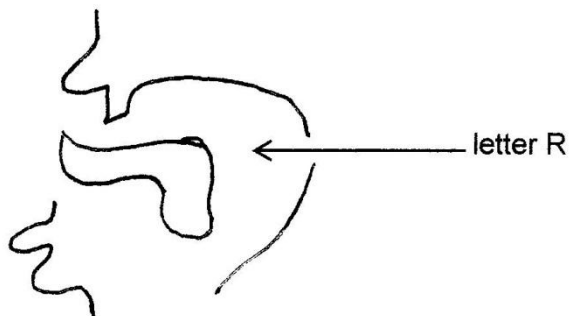
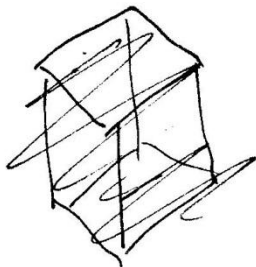

The mobility of tongue - makes us human.

"If we can control the tongue, we can control the whole body".

Brain = house where the ruler is

CHAOS = Cover on the light
human brain radiates energy into outer space.

Everything above palette is called "heaven"
below palette is called "earth"

Brain = egg shaped light energy which produces a mercurial light (Messianic light).

Physical brain one can take out of skull has been formed by golden egg of life.

Brain is precipitate of intelligent soul.

~~Only by the manifestation~~

"The state" aims at stability.

Leviathan (left-handed twister).

If there is serial presentation and co-ordination of the presentation, then logically there must be simultaneous presentation.

- verbalise and articulate their different presentations.

In temporal world by splitting human protoplasm and . . .

"collective human soul" there is a level of consciousness that assimilates experience of whole group.

~~The bio-field of~~

We are only talking about time when we talk about serial emission of energy on particular pathways.



Symbolises air hole

3 fold field itself

- a) form (presented in consciousness)
- b) energy (to hold in consciousness)
- c) evaluation in sentience

Therefore simultaneous presentation of thought, feeling and willing.

(thoughts are made of energy and
(by nature of being they are
(self-evaluating.

Time = serialisation of content of eternity.

Eternal beings = because we simultaneously
think, feel, will.

Temporal beings = because we move serially.



Plato = places the good, the true and the beautiful.

the true is called "the sun (son) of the good".

the good = power

the true = the formal aspect of its mode of operation

the beautiful = the aesthetic evaluation of this

All forms are definable

- will as power cannot be defined.
- one may have "intent"
ie power held in.

Plato - was on oath not to reveal at microcosmic level the hierarchy.

Therefore he said "the true" (taking precedence over "the good",
he did not say "the good" he said "the spirited element".

~~Predict~~

Plato was leg pulling when he said at macrocosmic level "the hierarchy was the good, true and beautiful (which is correct) and that at microcosmic level of man it is "the true, the good and beautiful".

Larynx = the outspeaker of law.

Energy belong to conation.

We cannot think without energy expenditure.

Energy expenditure is all joy.

Limitation of expenditure is all misery.

The soul in man pre exists its own creation

3 fold non-serialised

and absolutely eternal

Memory involves energy immission [sic].

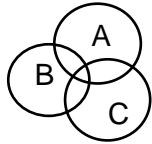

S L

Spirit
Bound (L = ligature)

Spirit self-bound.

~~Continuum is not~~

Within the eternal continuum, all beings are absolutely inter-penetrating.

Ⓐ = Absolute

Ⓑ = Bound

Ⓒ = Looking

⊥ Psi-zone is zone where there is leakage from one zone to another.

Chaos = does not mean rubbish

= inhibited wisdom

ie A B C are interpenetrating

Therefore in chaos neither A, B or C can tell what they would be like without interference from B and C



= Symbol of Saturn
of hammering down.

The only way to be oneself is to be isolated.

Because it is hammered down it is dense and because it is dense it is judged - ie evaluated by other human beings.

The one law that is eternal

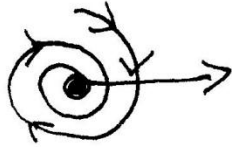

The above is law of “ejaculation”.

Energy spiralled in and condenses eventually shoots out.

Conquering energy is Q energy.

When one is in time one always has the choice:

Shall I isolate myself?

Shall I co-operate?

Any beings who pursue isolated activity are pursuing the time process.

Eternal Hierarchy

Power)
)
Form)
)
Function)

In this world men dig worms up, instead of worms digging men up.

The key to real joy is the acceptance of one’s own level. “Better one’s own job badly done than another’s job badly done”.

[the next two lines are marked as page 7 but the next page is also marked 7 so they are inserted here]

the working state = external form identified.

There is a lot more form in the unconscious than in the conscious.

Question - Discussion

- "People" = those who bend the knee to the external stimulus
- Conscious = Your being cut into bits,
assimilated and essence synthesised.
(ie self-comprehension).
- God = macrocosmic intelligent power
= unconsciousness
ie total wisdom
one is wiser at unconscious level than one could
be at the waking level.
- Torya = gradually encroach on sleeping state, and watch
dreaming state one would have if one went to sleep.

The state of "bliss" is not necessarily the best state.

Morality = murality - ie that which maintains the status quo.

Nietzsche said "I write in blood", "I will be read in blood".

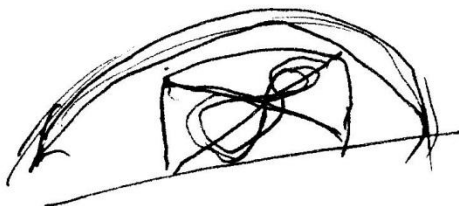

5 Levels of identification

- Physical body -
- Life force - (biofield)
- Collective ancestral knowledge
- Collective formal - of unwise
- Absolute will

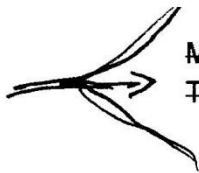

~~Movement of all beings are moving one.
Therefore ones own response is infinite in so far as one~~

There are no values in universe except those inserted into it by people.

If people want it they can't be it.



Identification determines energy.

- Egypt = imperial materialistic rationalism.
- Moses = lifted out of water totality of ancestral impulses (these are "elect").
- Pharoh = rational light - illuminated by empirical reason.
- inertias of rationality.
- Arons rod = psychic emotion charge not yet separated out from ideas.
- 1. marsh (confusion of thought)

Desert = place of sand
- granularity
no emotion there.

granularity looks only at form, and turns off emotive charge.

Objective fact as objective fact.

Clarify ideas and one then will see in distance true P Law all forms are one form.

One then focusses on Py Law

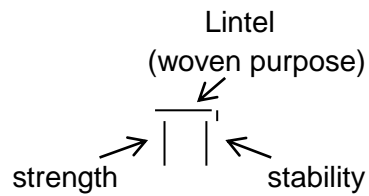

Solomon = peace evaluation
↑
spirit posited here/now

what you posit is self-realised by positivity.

you posit it and it doesn't matter how other people evaluate it.

Inherent rationality
- Eternal

(Last Sunday in Oct
25.10.1970